



PUSH BOTTON STATIONS NEMA 7, NEMA 7 + 4X TYPE SXE
HAZARDOUS LOCATIONS, DUST TIGHT & WATERTIGHT. JUNCTION BOXES & ENCLOSURES
CLASS 1, DIV. 1&2, GROUPS C-D; CLASS II, GROUPS E-F-G; CLASS III.



USE

Type SXE Pushbutton stations are used for remote control of electrical motors installed in hazardous locations.

FEATURES AND MATERIALS

- Enclosures made of cast aluminum.
- Slotted cast on aluminum mounting feet.
- Stain steel cover screw.
- Drilled and Tapped openings.
- **Outside:** Grey Electrostatic polyester paint.
- Different layouts with push buttons, pilot lights and selector switches.

OPTIONAL

- Drain breather.
- Drain valve.
- External epoxy enamel.
- External e internal epoxy enamel.
- Acrylic identification plates.

COMPLIANCES AND APPLICABLE STANDARDS

- **NEMA 7.**
- **UL 1203:** (ENCLOSURES) Explosion Proof and Dust-Ignition-Proof Electrical Equipment for use in Hazardous (Classified) Locations.
- **NTC 3229:** Norma Técnica Colombiana Electrotecnia cajas y accesorios que se utilizan en sitios clasificados como de alto riesgo.
- **RETIE:** Reglamento técnico de instalaciones eléctricas.



FILE E161224
ENCLOSURE



CIDET
CERTIFICADO
No. 02510
RETIE



PUSH BOTTON STATIONS NEMA 7, NEMA 7 + 4X TYPE SXE HAZARDOUS LOCATIONS, DUST TIGHT & WATERTIGHT. JUNCTION BOXES & ENCLOSURES

CLASE 1, DIV. 1 & 2, GRUPOS C - D; CLASE II, GRUPOS E-F-G; CLASE III

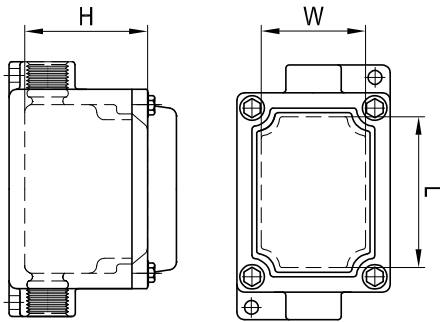

FILE E161224
ENCLOSURE

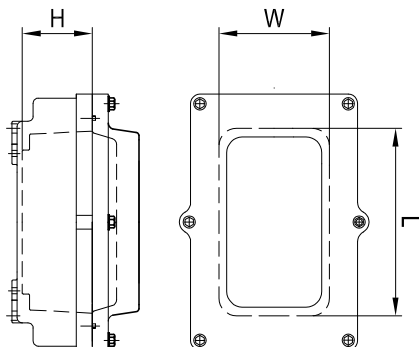

TABLE 1: BOXES FOR ELECTRICAL DEVICES

REFERENCE	DIMENSIONS mm			KING OF PROTECTION	CERTIFICATIONS
	LARGO (L)	ANCHO (W)	ALTO (H)		
SXE1	169	100	110	NEMA 7	UL
SXE2	140	140	132	NEMA 7 + 4X	RETIE
SXE3	235	180	125	NEMA 7 + 4X	UL
SXE4	169	100	145	NEMA 7	RETIE
SXE5	355	85	90	NEMA 7	RETIE
SXE6	355	125	90	NEMA 7	RETIE

TABLE 2: ELECTRICAL DEVICES

ELECTRIC DEVICES DESCRIPTION	REFERENCE*
START PUSH BUTTON	PA
STOP PUSH BUTTON	PP
MUSHROOM HEAD PULL PUSH BUTTON	PH
MUSHROOM HEAD PULL PUSH BUTTON KEY OPERATED	PHL
RED PILOT LIGHT	LR
GREEN PILOT LIGHT	LV
AMBER PILOT LIGHT	LA
TWO POSITIONS SELECTOR SWITCH	S2
THREE POSITION SELECTOR SWITCH	S3
TWO POSITIONS SELECTOR SWITCH KEY OPERATED	S2L
THREE POSITION SELECTOR SWITCH KEY OPERATED	S3L

* INDICATE THE NUMBER OF EQUIPMENT REQUIRED BEFORE THE BASE REFERENCE.
* INDICATE NOMINAL VOLTAGE FOR PILOT LIGHTS.

TABLE 3: OPENINGS

THROW HOLE DIAMETER	ONE OPENING	TWO OPENINGS
1/2"	1050	050
3/4"	1075	2075
1"	1100	2100

REFERENCE SETTING

Table 1
(Boxes for electrical devices)

+ **Table 2**
(Electrical devices)

+ **Table 3**
(Opening)

EJEMPLO

Para solicitar una botonera, un pulsador de arranque, un pulsador de parada, un selector de tres posiciones y 1 perforación de 1"; la referencia es la siguiente:

SXE3	1PA	1PP	1S3	1100
↓	↓	↓	↓	↓
Caja apta para tres elementos	Un pulsador de arranque	Un pulsador de parada	Un selector de tres posiciones	Un acceso roscado NPT de 1"



HAZARDOUS LOCATIONS SEALING FITTINGS TYPE EYA, EYAM, EYD AND EYDM. CLASS 1, DIV. 1&2, GROUPS C-D; CLASS II, GROUPS E-F-G; CLASS III.



FEATURES AND MATERIALS

- Threaded ends; type EYAA/EYA (Female/Female), type EYAD/EYD (Female/Female plus drain breather), or Male/Female through installation of one removable nipple, type EYAAM/EYAM and EYADM/EYDM (Male/Female plus drain breather).
- Easy installation of fiber compound sealing.
- Integral bushings inside to protect conductor insulation from damage.
- Vertical and horizontal installation.
- Body of Cast Aluminum or Nodular or Malleable Iron, all manufactured according UL-886 standards.
- Plugs of cast aluminum or malleable iron.
- Nipples of conduit type IMC, for sealing fittings type EYAM, EYAAM, EYDM and EYADM.
- Drain Breather in stainless steel for sealing fittings type EYD, EYAD, EYDM and EYADM with opening plug in cast aluminum.
- NPT threads for rigid conduit from 1/2" to 6".

USE

For use in conduit installations for:

- Restrict the passage of gases, vapor flames from one section of the electrical installation to another, at atmospheric pressure and normal ambient temperature.
- Limit "pressure pilling" effect. Limit explosion to the sealed-off enclosure

In Class I, Div. 1

- Sealing fittings are required at any entrance of an enclosure or fitting housing terminals splices or taps.

In Class I, Div. 1 & 2

- Sealing fittings are required at each entrance to an enclosure housing an arcing or sparking device. They should be installed as close as practicable and, in no case, farther than 18" from enclosure.
- Cable systems when cables do not have gas/vaportight continuous sheath or when they are capable of transmitting gases or vapors through the cable core when those cables leave the Class I, Div. 1 or 2 hazardous locations.
- In conduit installations when passing from a Class I, Div. 1 classified area to a Class I, Div. 2.

FINISH

Grey electrostatic polyester paint for sealing fittings on cast aluminum and Electro deposited zinc coatings for sealing fittings on Iron alloy and optional coatings for use in aggressive environments.

COMPLIANCES AND APPLICABLE STANDARDS

- **NEMA 7:** National Electric Manufacturing Association.
- **UL 886:** (OUTLET BOXES) Outlet Boxes and Fittings for use in Hazardous (Classified) Locations.
- **NTC 3229:** Norma Técnica Colombiana Electrotecnia. Cajas y accesorios que se utilizan en sitios clasificados como de alto riesgo.
- **NEC art 500-503:** National Electric Code.
- **ASTM A-536:** Ductile and Malleable iron.
- **RETIE:** Reglamento técnico de instalaciones eléctricas.

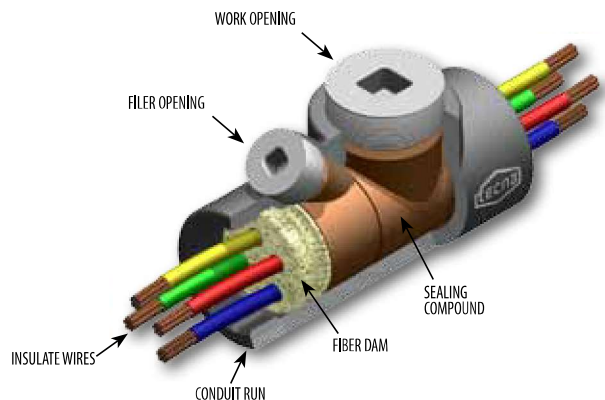

24



CAST ALUMINUM

DÍAMETER (Inches)	REFERENCE		CERTIFICATION	SEALING COMPOUND REQUIERED		APROX. FIBER REQUIERED Gramos
	H-H	H-M		Gramos	Libras	
1/2"	SX1EYAA 050	SX1EYAAM 050	RETIE	19	0,04	1,5
3/4"	SX1EYAA 075	SX1EYAAM 075	RETIE	28	0,06	3
1"	SX1EYAA 100	SX1EYAAM 100	RETIE	55	0,12	3
1 - 1/4"	SX1EYAA 125	SX1EYAAM 125	RETIE	143	0,32	4
1 - 1/2"	SX1EYAA 150	SX1EYAAM 150	RETIE	150	0,33	9
2"	SX1EYAA 200	SX1EYAAM 200	RETIE	264	0,58	11
2 - 1/2"	SX1EYAA 250	SX1EYAAM 250	RETIE	546	1,20	15
3"	SX1EYAA 300	SX1EYAAM 300	RETIE	740	1,63	21
4"	SX1EYAA 400	SX1EYAAM 400	RETIE	1600	3,53	26
6"	SX1EYAA 600	SX1EYAAM 600	RETIE	5900	13,01	100

NOTE: Also available with drain breather, consult factory.



SX1EYA -SX1EYAA



SX1EYM - SX1EYAAM

MALLEABLE IRON

DÍAMETER (Inches)	REFERENCE		CERTIFICATION	SEALING COMPOUND REQUIERED		APROX. FIBER REQUIERED Gramos
	H-H	H-M		Gramos	Libras	
1/2"	SX1EYA 050	SX1EYAM 050	UL	19	0,04	1,5
3/4"	SX1EYA 075	SX1EYAM 075	UL	28	0,06	3
1"	SX1EYA 100	SX1EYAM 100	UL	55	0,12	3
1 - 1/2"	SX1EYA 150	SX1EYAM 150	UL	143	0,32	4
2"	SX1EYA 200	SX1EYAM 200	UL	150	0,33	9
2 - 1/2"	SX1EYA 250	SX1EYAM 250	UL	264	0,58	11
3"	SX1EYA 300	SX1EYAM 300	UL	546	1,20	15
4"	SX1EYA 400	SX1EYAM 400	UL	740	1,63	21

NOTE: Also available with drain breather, consult factory.



SX1EYD - SX1EYAD



SX1EYDM - SX1EYADM

SEALING COMPOUND

REFERENCES	QUANTITY BY LBS"
IXXC 01	1
IXXC 05	5
IXXC 10	10

FIBER

REFERENCES	QUANTITY BY LBS"
LXXCHICOX	1





THREADED COVER RECTANGULAR ENCLOSURES, INSTRUMENT BOXES, GLASS WINDOWS

CLASS 1, DIV. 1&2, GROUPS C-D; CLASS II, GROUPS E-F-G; CLASS III



USE

Indoor and outdoor boxes type SX9GUB for junction, pull, splice, end-use electrical devices and instruments, for use in hazardous locations.

FEATURES AND MATERIALS

- Five different box sizes. Cast aluminum box and cover manufactured according **UL-1203** standard.
- Custom entries arrangements can be threaded in factory. **NPT** threads for rigid metallic conduit.
- Slotted mounting lugs.
- O'ring gasket for outdoor use and grounding bolt in bronze.
- Threaded large cover opening for easy access and maintenance, aluminum mounting panel.

FINISH

Outside: Grey Electrostatic polyester paint.

Optionals: Epoxy and Polyurethane paint for use in aggressive environments.

Inside: Grey enamel paint.

OPTIONALS

- Glass windows of different diameters, for use in classified areas.
- Drain breather in stainless steel, tapped openings.
- Instruments and assembled electrical equipment (*) for measuring and controlling.
- Enclosures can include four different type of covers: Flat cover, Flat cover with a window, Dome cover, Dome cover with a window; all with threaded adjustment.

COMPLIANCES AND APPLICABLE STANDARDS

- NEMA 7, NEMA 9 Y NEMA 4X, NEMA 3.**
- UL 1203:** Explosión Proof and Dust-Ignition-Proof Electrical Equipment for use in Hazardous (Classified) Locations.
- UL 50:** (Cabinets and Boxes).
- NTC 3229:** Norma Técnica Colombiana Electrotecnia. Cajas y accesorios que se utilizan en sitios clasificados como de alto riesgo.
- NEC art 500-503:** National Electric Code.

CAJA CON TAPA CIEGA / FLAT COVER

REFERENCIA REFERENCE	DIMENSIONES DIMENSIONS mm LWH (mm)	CERTIFICACIÓN CERTIFICATIONS	DIAMETRO MAXIMO MAXIMUM DIAMETER NPT
SX9GUAG	86 x 86 x 55	RETIE	1-1/4"
SX9GUB1A	148 x 148 x 130	UL	2"
SX9GUB2A	198 x 219 x 138	UL	2"
SX9GUB3A	244 x 270 x 161	UL	4"
SX9GUB4A	440 x 440 x 295	RETIE	4"

CAJA CON TAPA PLANA CON MIRILLA/FLAT COVER WITH WINDOW

REFERENCIA REFERENCES	DIMENSIONES INTERNAS INT BOX DIMENSIONS LWH (mm)	CERTIFICACION CERTIFICATIONS	DIAMETRO MAXIMO MAXIMUM DIAMETER NPT	DIAMETRO UTIL MIRILLA WINDOW DIAMETER mm
SX9GUABW1A-45	148 x 148 x 130	UL	2"	45
SX9GUABW1A-80	148 x 148 x 130	RETIE	2"	80
SX9GUABW2A-45	198 x 219 x 138	RETIE	2"	45
SX9GUABW2A-80	198 x 219 x 138	UL	2"	80
SX9GUABW2A-125	198 x 219 x 138	RETIE	2"	125
SX9GUABW3A-45	244 x 270 x 161	RETIE	4"	45
SX9GUABW3A-80	244 x 270 x 161	RETIE	4"	80
SX9GUABW3A-125	244 x 270 x 161	UL	4"	125

TAPA CON TAPA TIPO DOMO CIEGA / DOME COVER

REFERENCIA REFERENCES	DIMENSIONES DIMENSIONS LWH (mm)	CERTIFICACION CERTIFICATIONS	DIAMETRO MAXIMO MAXIMUM DIAMETER NPT
SX9GUBD1A	148 x 148 x 130	UL	2"
SX9GUBD2A	198 x 219 x 138	UL	2"

CAJA CON TAPA TIPO DOMO CON MIRILLA / DOME COVER WITH WINDOW

REFERENCIA REFERENCES	DIMENSIONES DIMENSIONS MM LWH (mm)	CERTIFICACION CERTIFICATIONS	DIAMETRO MAXIMO MAXIMUM DIAMETER NPT"	DIAMETRO UTIL MIRILLA WINDOW DIAMETER mm
SX9GUBDW1A-45	148 x 148 x 130	UL	2"	45
SX9GUBDW1A-80	148 x 148 x 130	RETIE	2"	80
SX9GUBDW2A-45	198 x 219 x 138	RETIE	2"	45
SX9GUBDW2A-80	198 x 219 x 138	UL	2"	80
SX9GUBDW2A-125	198 x 219 x 138	RETIE	2"	125

Nota:
Todas las dimensiones son aproximadas. Especificaciones sujetas a cambios sin previo aviso.

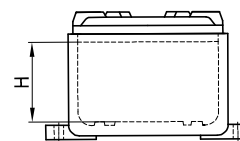
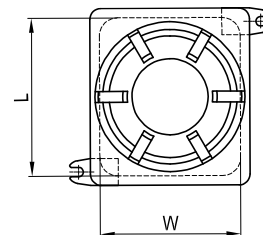



UNIVERSAL CONDUIT UNIONS TYPE SX2UNF, SX2UNY, SX2UNFA, SX2UNYA, SX2UNFG FOR USE IN HAZARDOUS LOCATIONS

CLASS 1, DIV. 1&2, GROUPS B-C-D; CLASS II, GROUPS E-F-G; CLASS III (See uses)



FINISH

Grey electrostatic polyester paint for universal conduit unions on cast aluminum, Electro deposited zinc coatings for those on Ductile or Malleable Iron and optional coatings in all references, for use in agresive enviroments.

OPTIONALS

Female/Female insulated Universal Unions type **UNFG** for Class I, Div. 1&2, Groups C-D; Class II, Groups E-F-G, Class III.

COMPLIANCES AND APPLICABLE STANDARDS

- **NEMA 7:** National Electric Manufacturing Association.
- **UL 886:** (OUTLET BOXES) Outlet Boxes and Fittings for use in Hazardous (Classified) Locations.
- **NTC 3229:** Norma Técnica Colombiana Electrotecnia. Cajas y accesorios que se utilizan en sitios clasificados como de alto riesgo.
- **NEC art 500-503:** National Electric Code.
- **ASTM A-536:** Ductile and Malleable iron.
- **ASTM B-633:** Electrodeposited Coatings of Zinc on Iron and Steel.
- **RETIE:** Reglamento técnico de instalaciones eléctricas.

USE

For use in Conduit Installations for:

- Class I, Div. 1&2, Groups C-D; Class II, Div. 1&2, Groups E-F-G; CLASS III for bodies from 1/2" to 4" in nodular or malleable iron.
- Class I, Div. 1&2, Groups C-D; Class II, Div. 1&2, Groups E-F-G; CLASS III for bodies from 1/2" to 1" in steel.
- Class I, Div. 1&2, Groups C-D; Class II, Div. 1&2, Groups E-F-G; CLASS III for bodies from 1/2" to 6" in cast aluminum.
- Class I Div. 1&2, Groups B-C-D; Class II, Div 1&2, Group E-F-G; Class III only for dobies of 1 1/2" and 2" in nodular or malleable iron.
- Threaded thickwall conduit systems.
- Female/Male to connect rigid conduit to enclosures, junction boxes and conduit fittings.
- Female/Female to connect conduit to conduit.
- Easy installation, maintenance and inspection.
- To provide means for future modifications, addition or remotion of enclosures without turning conduits.

FEATURES AND MATERIALS

- Threaded ends; type **UNF/UNFA** (Female/Female) and type **UNY/UNYA** (Male/Female).
- Integral bushings inside to protect conductor insulation from damage.
- Compact design that allows assembly with a minimum of clearan- ce to other adjacent conduit and/or equipment.
- Strong construction (Heavy Duty).
- **NPT** threads for rigid conduit from 1/2" to 6".
- **UNFA/UNYA:** Aluminium, **UNF/UNY** steel SAE12L14 from 1/2" to 1" and ductile or malleable Iron for bodies from 1/2" to 6".





TABLA UNIONES

Diameter (Inches)	Reference	CERTIFICADO	Body Material	Weight (Kg)
FEMALE - FEMALE				
1/2"	SX2UNF 050	UL	*	0,131
3/4"	SX2UNF 075	UL	*	0,171
1"	SX2UNF 100	UL	*	0,242
1-1/2"	SX2UNF 150	UL	**	0,764
2"	SX2UNF 200	UL	**	1,3
2-1/2"	SX2UNF 250	UL	**	1,91
3"	SX2UNF 300	UL	**	2,9
4"	SX2UNF 400	UL	**	4,9
1/2"	SX2UNFA 050	RETIE	***	0,058
3/4"	SX2UNFA 075	RETIE	***	0,096
1"	SX2UNFA 100	RETIE	***	0,132
1-1/4"	SX2UNFA 125	RETIE	***	0,35
1-1/2"	SX2UNFA 150	RETIE	***	0,36
2"	SX2UNFA 200	RETIE	***	0,45
2-1/2"	SX2UNFA 250	RETIE	***	0,6
3"	SX2UNFA 300	RETIE	***	1,1
4"	SX2UNFA 400	RETIE	***	1,4
6"	SX2UNFA 600	RETIE	***	3,3
MALE-FEMALE				
1/2"	SX2UNY 050	UL	*	0,142
3/4"	SX2UNY 075	UL	*	0,188
1"	SX2UNY 100	UL	*	0,281
1-1/2"	SX2UNY 150	UL	**	0,764
2"	SX2UNY 200	UL	**	1,3
2-1/2"	SX2UNY 250	UL	**	1,91
3"	SX2UNY 300	UL	**	2,9
4"	SX2UNY 400	UL	**	4,9
1/2"	SX2UNYA 050	RETIE	***	0,063
3/4"	SX2UNYA 075	RETIE	***	0,105
1"	SX2UNYA 100	RETIE	***	0,144
1-1/4"	SX2UNYA 125	RETIE	***	0,33
1-1/2"	SX2UNYA 150	RETIE	***	0,34
2"	SX2UNYA 200	RETIE	***	0,46
2-1/2"	SX2UNYA 250	RETIE	***	0,62
3"	SX2UNYA 300	RETIE	***	1,13
4"	SX2UNYA 400	RETIE	***	1,43
6"	SX2UNYA 600	RETIE	***	3,5
MALE-FEMALE (INSULATED)				
1/2"	SX2UNFG 050	RETIE	*	0,131
3/4"	SX2UNFG 075	RETIE	*	0,171
1"	SX2UNFG 100	RETIE	*	0,242
1-1/2"	SX2UNFG 150	RETIE	*	0,764
2"	SX2UNFG 200	RETIE	*	1,3
2-1/2"	SX2UNFG 250	RETIE	*	1,91
3"	SX2UNFG 300	RETIE	*	2,9
4"	SX2UNFG 400	RETIE	*	4,9



F-F



M-F



* STEEL BODY
 ** NODULAR OR MALLEABLE IRON BODY
 *** ALUMINUM BODY

Nota: Todos los pesos son aproximados. Especificaciones sujetas a cambios sin previo aviso.



HAZARDOUS LOCATIONS, DUST TIGHT & WATERTIGHT. JUNCTION BOXES & ENCLOSURES

CLASS 1, DIV. 1&2, GROUPS C-D; CLASS II, GROUPS E-F-G; CLASS III.



USE

Indoor and outdoor boxes type **SX7E** for junction, pull, splice, enclose electrical devices and instruments, for use in hazardous locations.

FEATURES AND MATERIALS

- Wide selection of sizes. Cast aluminum box and cover manufactured according **UL-886** standards.
- Custom entries arrangements can be threaded in factory.
- **NPT** threads for rigid metallic conduit.
- Includes mounting lugs.
- O'ring gasket for outdoor use, grounding bolt in bronze and mounting panel.

FINISH

- **Outside:** Grey Electrostatic polyester paint.
- **Optionals:** Epoxy and Polyurethane paint for use in aggressive environments.
- **Inside:** Grey enamel paint.

OPTIONALS

- Glass windows of different diameters, for use in classified areas.
- Drain breather in stainless steel, tapped openings.
- Instruments and assembled electrical equipment (*).

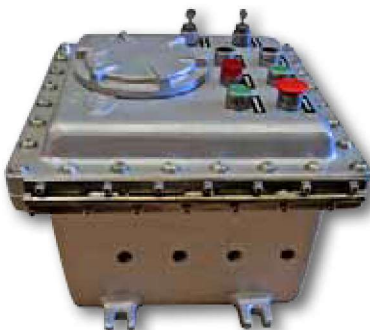

A prueba de:

- Chorro de agua
- Explosión
- Corrosión
- Polvos inflamables

COMPLIANCES AND APPLICABLE STANDARDS

- **NEMA 7, NEMA 9, NEMA 4X, NEMA 3.**
- **UL 886:** (OUTLET BOXES) Outlet Boxes and Fittings for use in Hazardous (Classified) Locations.
- **UL 1203:** Explosion Proof and Dust-Ignition-Proof Electrical Equipment for use in Hazardous (Classified) Locations.
- **NTC 3229:** Norma Técnica Colombiana Electrotécnica. Cajas y accesorios que se utilizan en sitios clasificados como de alto riesgo.
- **NEC Art 500-503:** National Electric Code.
- **RETIE:** Reglamento técnico de instalaciones eléctricas.



OPTIONALS FOR SEVERAL APPLICATIONS: ASSEMBLED ELECTRICAL EQUIPMENT

- Switchracks.
- Full voltage motor starters.
- Star-Delta motor starters.
- Manual motor starters.
- Circuit breakers.
- Control stations.
- Terminal blocks junction boxes.
- Lighting pole splite boxes.
- Pilot lights.
- Power distribution panel boards.
- Lighting panelboards.



CAJAS DE SOBREPONER

REFERENCE	NOMINAL DIMENSIONS L W H (INCHES)	INSIDE DIMENSIONS L W H mm	INSIDE DIMENSIONS WITH VEINS L1 W1 H1 mm	CERTIFICATION	MAXIMUM DIAMETER THREADED NPT (INCHES)	ESTIMATED WEIGHT (Kg)
SX7E 644	6" x 4" x 4"	154 x 105 x 102		UL	2	6,1
SX7E 664	6" x 6" x 4"	154 x 154 x 107		UL	2	8,6
SX7E 666	6" x 6" x 6"	154 x 154 x 150		UL	2	9,0
SX7E 668	6" x 6" x 8"	156 x 156 x 207		RETIE	2	14,3
SX7E 764	7" x 6" x 4"	198 x 151 x 104		RETIE	2	10,3
SX7E 864	8" x 6" x 4"	205 x 152 x 105		UL	2	11,0
SX7E 86B	8" x 6" x 11"	212 x 150 x 286		RETIE	2	20,1
SX7E 883	8" x 8" x 3"	220 x 218 x 87		UL	2	9,40
SX7E 884	8" x 8" x 4"	204 x 205 x 108		UL	2	11,0
SX7E 886	8" x 8" x 6"	204 x 204 x 154		RETIE	2	17,1
SX7E 888	8" x 8" x 8"	205 x 204 x 200		UL	2	13,0
SX7E A66	10" x 6" x 6"	252 x 152 x 155		UL	2	13,5
SX7E A86	10" x 8" x 6"	257 x 207 x 155		RETIE	2	20,0
SX7E 866	8" x 6" x 6"	207 x 156 x 152		UL	4	11,3
SX7E AA6	10" x 10" x 6"	261 x 258 x 154		UL	4	20,5
SX7E C56	12" x 5" x 6"	300 x 136 x 157		UL	4	17,0
SX7E C88	12" x 8" x 8"	306 x 207 x 209		RETIE	4	29,4
SX7E CA6	12" x 10" x 6"	309 x 256 x 152		RETIE	4	29,5
SX7E CB6	12" x 11" x 6"	303 x 277 x 156		RETIE	4	30,4
SX7E CC4	12" x 12" x 4"	320 x 320 x 108		RETIE	4	28,0
SX7E CC6	12" x 12" x 6"	309 x 308 x 155		RETIE	4	29,5
SX7E CC8	12" x 12" x 8"	304 x 304 x 200		RETIE	4	35,7
SX7E E88	14" x 8" x 8"	360 x 210 x 204		RETIE	4	31,6
SX7E FC6	15" x 12" x 6"	375 x 304 x 157		UL	4	44,0
SX7E G86	16" x 8" x 6"	410 x 208 x 153		RETIE	4	36,6
SX7E GC6	16" x 12" x 6"	409 x 306 x 155		UL	4	43,8
SX7E GC8	16" x 12" x 8"	411 x 308 x 202		UL	4	45,0
SX7E GG6	16" x 16" x 6"	405 x 405 x 151		UL	4	46,8
SX7E GE9	16" x 14" x 9"	406 x 368 x 224		UL	4	58,6
SX7E GF6	16" x 15" x 6"	409 x 381 x 149		UL	4	44,8
SX7E IC8	18" x 12" x 8"	470 x 319 x 204	470 x 253 x 178	UL	4	55,2
SX7E IIC	18" x 18" x 12"	466 x 470 x 302	466 x 403 x 276	UL	4	92,9
SX7E KK8	20" x 20" x 8"	513 x 512 x 201	448 x 448 x 175	UL	4	93,2
SX7E MMA	22" x 22" x 10"	560 x 560 x 275	560 x 560 x 250	RETIE	4	135,0
SX7E OCC	24" x 12" x 12"	606 x 306 x 303	606 x 239 x 277	UL	4	86,2
SX7E OF6	24" x 15" x 6"	612 x 388 x 152	612 x 324 x 126	UL	4	78,4
SX7E OI8	24" x 18" x 8"	620 x 465 x 203	620 x 401 x 177	RETIE	4	97,6
SX7E OIB	24" x 18" x 11"	622 x 472 x 287	622 x 408 x 261	RETIE	4	112,5
SX7E OID	24" x 18" x 13"	620 x 465 x 347	620 x 395 x 321	RETIE	4	123,1
SX7E PP6	25" x 25" x 6"	635 x 635 x 149	635 x 571 x 123	RETIE	4	126,9
SX7E PPB	25" x 25" x 12"	635 x 635 x 301	635 x 568 x 275	RETIE	4	169,0
SX7E SG8	28" x 16" x 8"	716 x 410 x 200	716 x 346 x 174	UL	4	97,5
SX7E SGD	28" x 16" x 13"	716 x 410 x 355	716 x 340 x 329	UL	4	125,8
SX7E UOA	30" x 24" x 10"	750 x 604 x 257	750 x 542 x 231	RETIE	4	168,0
SX7E UOE	30" x 24" x 14"	763 x 612 x 354	763 x 538 x 328	RETIE	4	200,4
SX7E VIA	31" x 18" x 10"	800 x 450 x 248	800 x 384 x 222	RETIE	4	147,5
SX7 VL8	31" x 21" x 8"	790 x 533 x 194	790 x 469 x 168	RETIE	4	147,0
SX7 XCD	33" x 12" x 13"	839 x 316 x 343	839 x 246 x 317	UL	4	151,0
SX7 XG6	33" x 16" x 6"	854 x 403 x 148	854 x 339 x 122	RETIE	4	122,3
SX7E 360C	36" x 24" x 12"	914 x 610 x 305	914 x 610 x 275	RETIE	4	320,0
SX7E 43LA	43" x 21" x 10"	1102 x 538 x 253	1102 x 472 x 227	RETIE	4	233,0
SX7E 55QF	54" x 26" x 15"	1375 x 660 x 385	1375 x 660 x 350	RETIE	4	460,0

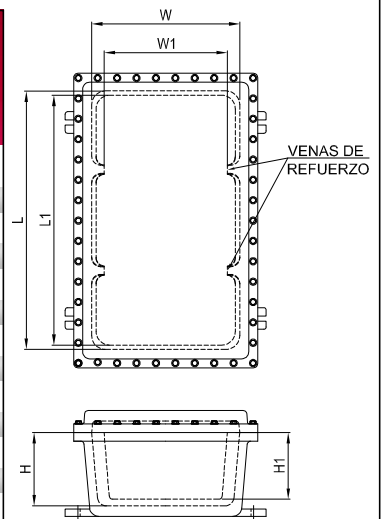

Note: The weight descriptions are an approximate measure. Specifications are subject to change without notice.